

Airport ball caster / Air cargo units

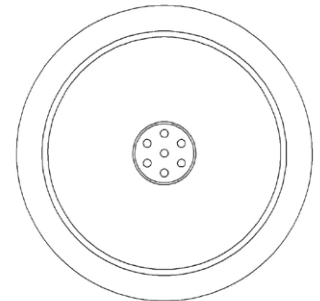
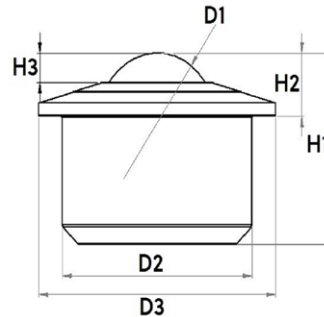
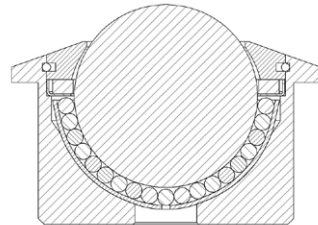

Designation	Material of bearing ball	Dimensioning						Sealing felt	Load bearing capacity (kg)
		Ø D1 (mm)	Ø D2 (mm)	Ø D3 (mm)	H1 (mm)	H2 (mm)	H3 (mm)		
Tolerances	-	-	+/- 0.1	+/- 0.2	+/- 0.2	+/- 0.2	-	-	-
Solid ball caster / ball transfer units with collar, galvanised (f = airport model)									
030.100f	Tool steel	30.000	45.0	55.0	37.0	14.0	6.0	yes	350
045.100f		44.500	62.0	75.0	53.5	19.0	9.0	yes	800
030.120f	Stainless steel	30.000	45.0	55.0	37.0	14.0	6.0	yes	350
045.120f		44.500	62.0	75.0	53.5	19.0	9.0	yes	800

Design and construction

This Schulz ball caster / air cargo unit consists of a casing and top cover as solid turned parts, a bearing ball and several support balls. Special model with separate ball cup as an airport ball caster.

Dimensions

The spacing is calculated by dividing the shortest edge length of the object to be transported by 3.5.

Materials

Casing:	tempered, galvanised steel, tempered stainless steel
Lid:	galvanised steel, stainless steel
Ball cup:	tempered steel, tempered stainless steel
Support balls:	tool steel (tempered), stainless steel (tempered)
Bearing ball:	tool steel (tempered), stainless steel (tempered), plastic

Operational conditions

Temperature range from -30°C to +100°C (up to +30°C with plastic bearing ball)
Conveyance velocity of up to 1.5 m/s.
Dynamic load rating up to max. 800 kg.