

## Solid ball caster with base flange and suspension

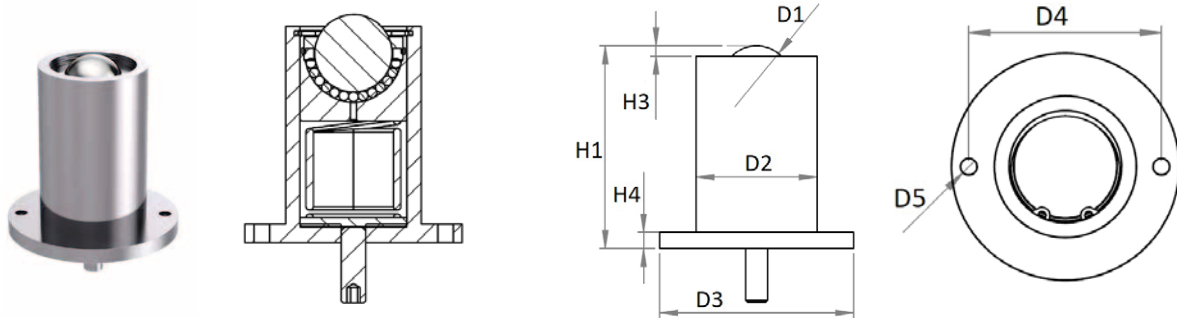

Designation	Material of Bearingball	Dimensioning								Sealing Felt	Load capacity of the ball transfer unit (kg) Attention higher than spring force!
		Ø D1 (mm)	Ø D2 (mm)	Ø H1 (mm)	H3 (mm)	H4 (mm)	D4 (mm)	Ø D5 (mm)	F1 (N) adjustable		
Tolerances	-	-	+/- 0.1	+/- 0.2	+/- 0.1	+/- 0.1	-	-	-	-	-
<b>Solid ball caster / ball transfer units with head flange and suspension, gunmetal-finished – low Suspension (FS)</b>											
012.701-FS	Tool Steel	12.70	25.40	32.10	1.70	5.00	36.00	5.10	100-120	no	80
025.701-FS		25.40	44.50	71.80	3.8	6	60.20	5.10	96-139	no	125
038.701-FS		38.10	70.00	121.00	7.00	10.00	92.00	10.10	340-420	no	350
050.701-FS		on request								yes	-
<b>Solid ball caster / ball transfer units with head flange and suspension, gunmetal-finished – medium Suspension (FM)</b>											
012.701-FM	Tool Steel	12.70	25.40	32.10	1.70	5.00	36.00	5.10	120-140	no	80
025.701-FM		25.40	44.50	71.80	3.8	6	60.20	5.10	187-283	no	125
038.701-FM		38.10	70.00	121.00	7.00	10.00	92.00	10.10	650-790	no	350
050.700-FM		on request								yes	-
<b>Solid ball caster / ball transfer units with head flange and suspension, gunmetal-finished– high Suspension (FL)</b>											
012.701-FL	Tool Steel	12.70	25.40	32.10	1.70	5.00	36.00	5.10	140-160	no	80
025.701-FL		25.40	44.50	71.80	3.8	6	60.20	5.10	298-485	no	125
038.701-FL		38.10	70.00	121.00	7.00	10.00	92.00	10.10	720-900	no	350
050.701-FL		on request								yes	-

## Solid ball caster with base flange and suspension

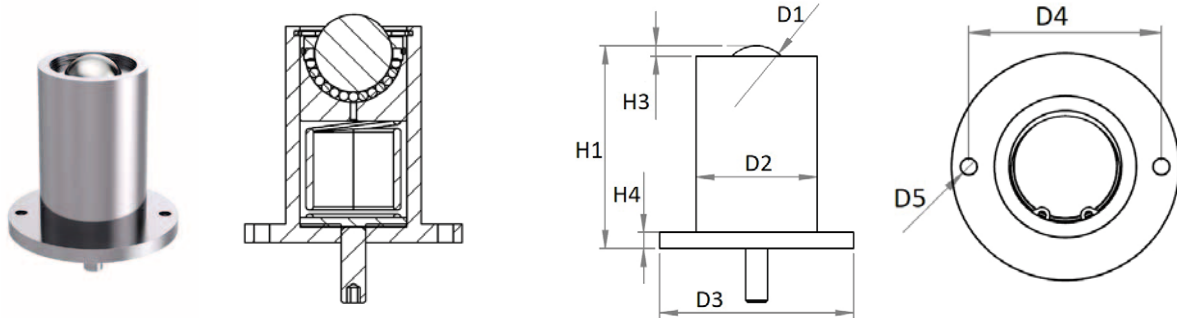

### Design and construction

This Schulz ball caster / ball transfer unit consists of a casing, a top cover and a bearing cap as solid turned parts, a bearing ball and several support balls. To this ball caster is another casing which serves as a body for the spring. Prevent spring loaded ball casters Damage caused by shock loads.

### Dimensions

The spacing is calculated by dividing the shortest edge length of the object to be transported by 3.5.

### Materials

<b>Casing Ball caster:</b>	galvanized Steel (tempered)
<b>Casing Spring:</b>	Steel
<b>Top Cover:</b>	galvanized Steel
<b>Ball socket:</b>	Steel (tempered)
<b>Support Balls:</b>	Tool Steel (tempered), Stainless Steel (tempered)
<b>Bearing Ball:</b>	Tool Steel (tempered), Stainless Steel (tempered), Plastic
<b>Spring:</b>	1.4310 or 1.200

### Operational conditions

Temperature range from -30°C to +100°C (bis +30°C Plastic)  
Conveyance velocity of up to 1,5 m/s.  
Dynamic load rating up to max. 2.500 kg.

\* depend on the adjustable force of suspension F1